



www.torneria-pizeta.it

PIZETA S.r.l.

Di Peron e Zerbato

TORNERIA AUTOMATICA A C.N.C.

Lavorazioni da barra con C.N.C. 5-11  
assi fantina fissa e mobile  
Diametri tornibili da 2 a 70mm  
Lavorazione su centri di lavoro

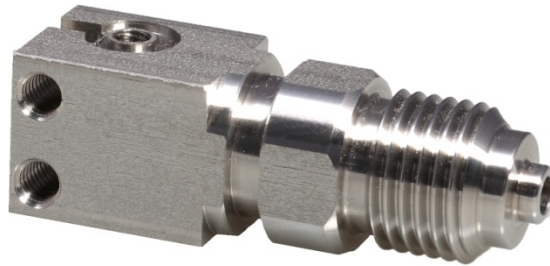

Description: Pressure gauge connector INOX AISI316L

- Sector: Automotive
- Material: INOX AISI316L
- Dimensions: square key 14; Length=45
- Most significant tolerances:  $\pm 0.02$  on holes;  $\pm 0.05$  on external diameters; lateral hole concentricity  $< 0.05$
- Most significant roughness:  $Ra < 1.6$  on seal zones